



**STRENGTHENING
OUR COMMUNITY,
BUILDING OUR FUTURE
TOGETHER**

Ivydale
School & Children's Centre

**WHAT MAKES
IVYDALE SPECIAL:
THE IVYDALE
DIFFERENCE**



OUR PROVISION

our teachers and our curriculum

OUR COMMITMENT

to developing the whole child including play
and inclusion

OUR COMMUNITY

relationship with families

OUR REALITY



**IN THE MEDIUM TERM
PRIMARY NUMBERS WILL
CONTINUE TO FALL.**

**FROM SEPTEMBER 2015 TO SEPTEMBER
2023 (DECEMBER 2022 FOR BIRTHS):**

- Total primary pupils have decreased by 15%
- Reception pupils have decreased by 21%
- Births have decreased by 26%
- Reception applications have decreased by 22%

Some areas in Southwark, particularly "Borough & Bankside" and "Peckham & Nunhead," have seen an even sharper drop in primary demand.

UNDERSTANDING CHANGE IN OUR COMMUNITY



FEWER FAMILIES

Fewer families living in Nunhead and Peckham and lots of school places free



INCREASED NEEDS

Increased pupil needs and not enough places for children in specialist settings and schools with specialist settings

BUDGET DEFICIT

Space and staffing for 120/90 pupils but only attracting 60-65 children leaves a shortfall of income

**OUR 2 SITES DESIGNED
FOR A LARGER PUPIL
BODY CANNOT BE
FUNDED BY IVYDALE
AS A MUCH SMALLER
SCHOOL**

**ALL SCHOOLS RECEIVE
£4610 MIN PER PUPIL PER
ANNUM.**

**SO A SHORTFALL OF 30
PUPILS IS £138,300 PER
YEAR GROUP PER YEAR
OR £968K PER SCHOOL
PER YEAR.**

OUR VISION FOR THE FUTURE: IVYDALE'S NEXT CHAPTER

Ivydale
School & Children's Centre

NEXT STEPS:

**CONSULTATION PROCESS FOR A PROPOSED
PUBLISHED ADMISSION NUMBER (PAN)
REDUCTION FROM 90 TO 60 PUPILS PER
YEAR GROUP FROM SEPTEMBER 2026'**



Ivydale
School & Children's Centre

NEXT STEPS:

**CONSOLIDATING OUR LEARNING SPACES TO
THE BELLWOOD SITE.**

**RENOVATING BELLWOOD TO ENSURE IT IS
HIGHER QUALITY AND FIT FOR THE FUTURE**



Ivydale
School & Children's Centre



**WHAT DOES
THIS LOOK LIKE?**



Ivydale
School & Children's Centre



A NEW NURSERY SPACE IN THE CHILDREN'S CENTRE.

KEY

- Remodelled / Refurbished Area
- Repurposed / Refreshed
- Unchanged
- WC's

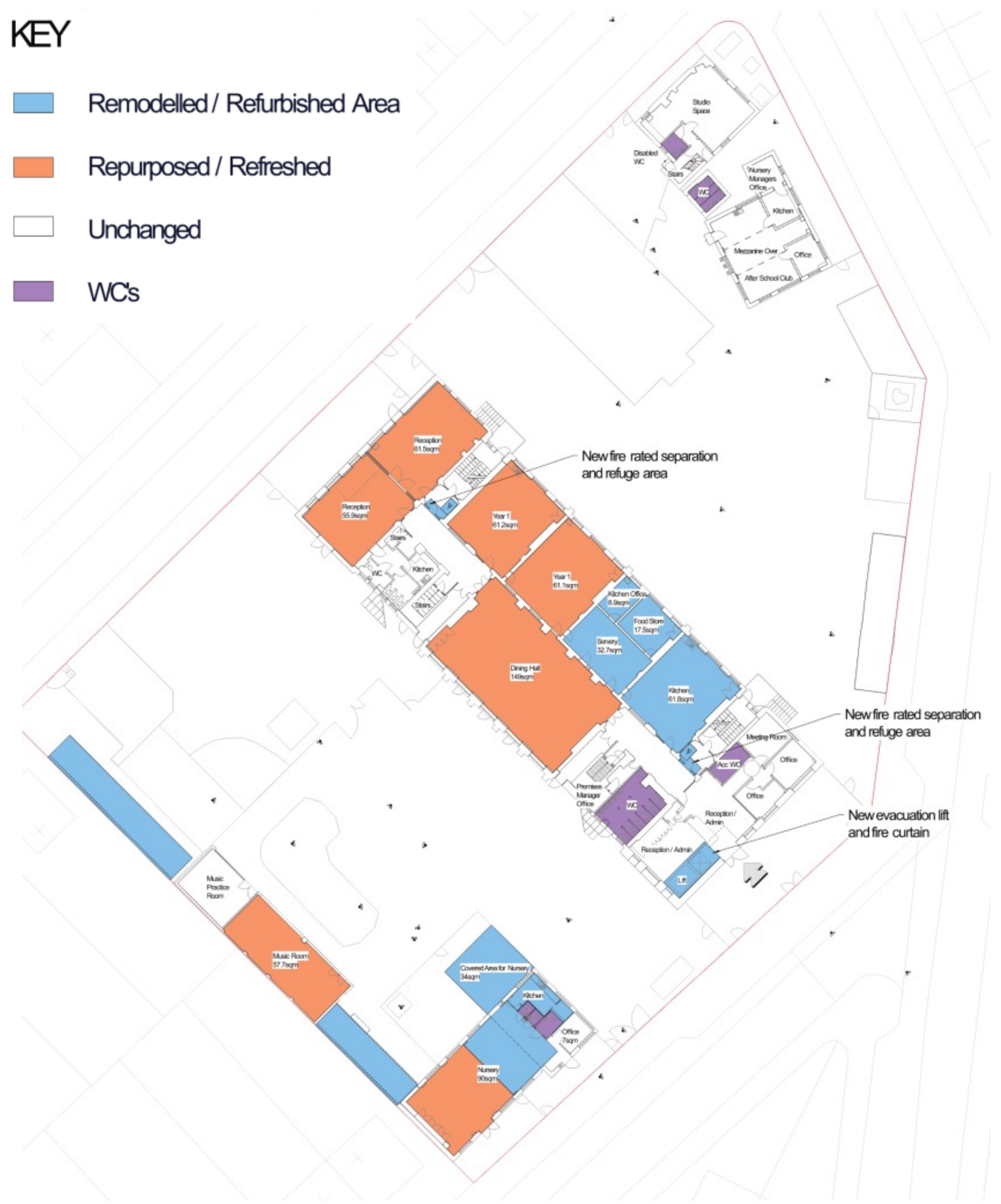

CREATING A NEW EARLY YEARS 'RECEPTION LEARNING SPACE' IN THE LOCATION OF THE CURRENT NURSERY.

KEY

- Remodelled / Refurbished Area
- Repurposed / Refreshed
- Unchanged
- WC's





RELOCATION OF KITCHEN AND DINING ROOM

- Keep deliveries and cooking on one level
- Provide children direct access to canteen-style dining from the playground
- Make the facilities more accessible for community use

BRAND NEW TECHNOLOGY LAB



BRAND NEW DESIGN AND FOOD TECHNOLOGY SPACE



**WE'RE GIVING ALL
OUR BELLWOOD
CLASSROOMS A
FACELIFT**

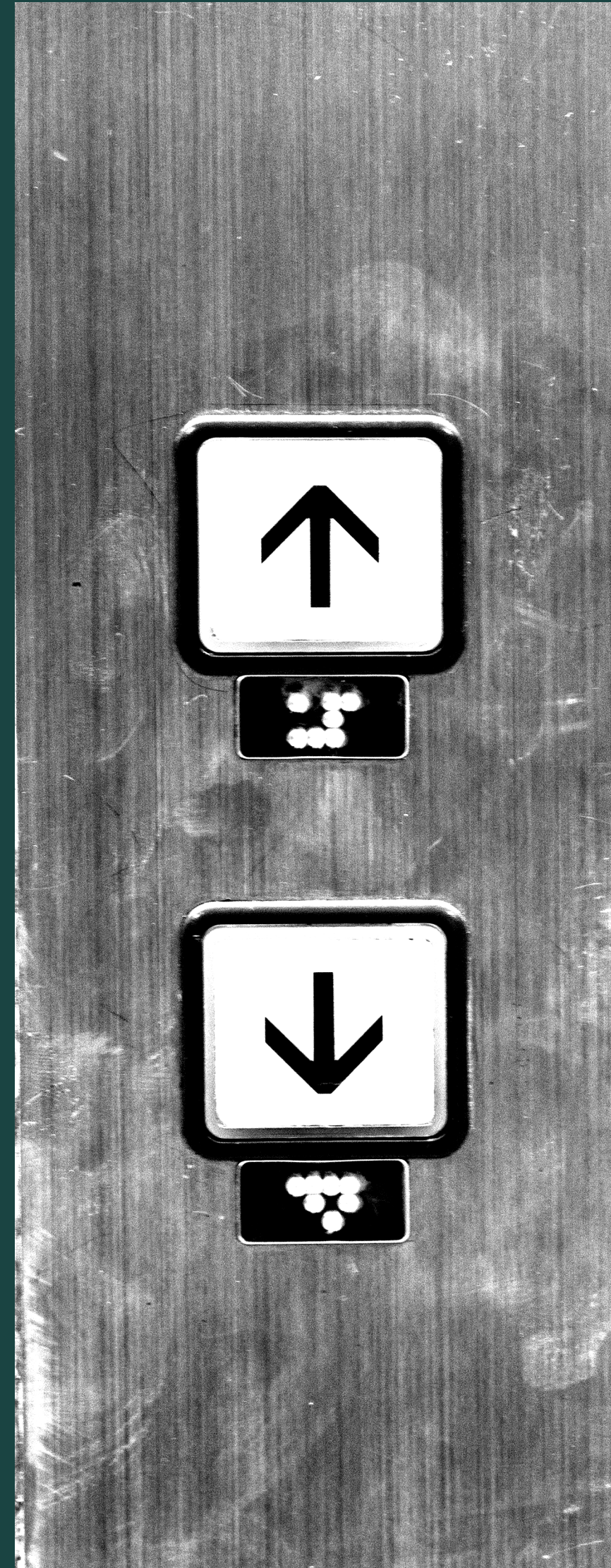

**WE'RE
INSTALLING
A LIFT SO ALL
FLOORS ARE
ACCESSIBLE
TO ALL**

**CONSOLIDATION PLANS:
HOW DOES
THIS HELP?**

THREE QUICK WINS

- Lower maintenance and non-staffing costs, including expenses for two kitchens, lunch provisions, and separate energy bills.
- Reduces our deficit without limiting the curriculum or reducing staffing.
- Our Bellwood site offers ample indoor and outdoor space and flexibility for our future.

CONSOLIDATION PLANS:

BENEFITS OF A

UNIFIED SITE

COMMUNITY

All pupils and staff in one place fosters a stronger sense of community.

COLLABORATION

Enhanced staff collaboration, contributing to a more cohesive learning environment.

OPPORTUNITY

Increased development opportunities for staff and a more unified student experience.

GATHERING YOUR VIEWS

YOUR FEEDBACK MATTERS AND WE WANT TO HEAR FROM YOU.

NEXT STEPS

1

STAFF MEETINGS

12th & 13th November

2

LETTER TO PARENTS

14th November

3

INFORMATION SESSIONS

21st November
(2:45pm & 6 pm)

25th November -Including age appropriate pupil assembly and pupil voice activities

4

STAFF REFLECTIONS

End of November

5

FAQS FOR PARENTS AND STAFF

Early December